

BUTLER

SPECIALTY COMPANY

Est. 1930

Assembly Instructions

6310488

6310497

6310498

Bench

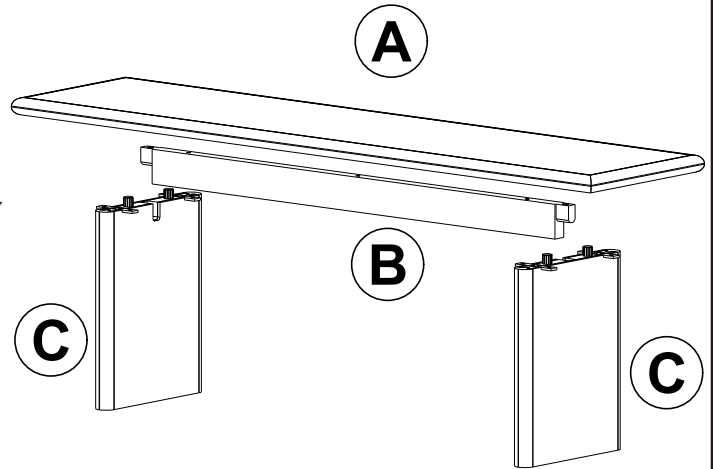
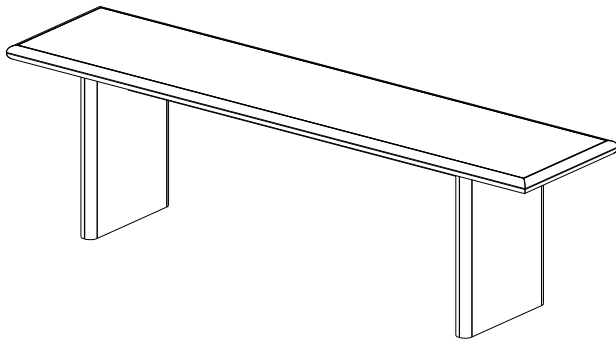

ITEM	DESCRIPTION	QUANTITY
A	Top Table	1 Pc
B	Stretcher	1 Pc
C	Leg	2 Pcs
D	JCBC M6 x 25 mm	8 Pcs
E	JCBC M6 x 40 mm	2 Pcs
F	JCBC M6 x 70 mm	3 Pcs
G	Lock Washer M6	13 Pcs
H	Flat Washer M6	13 Pcs
I	Allen Key 4	1 Pc

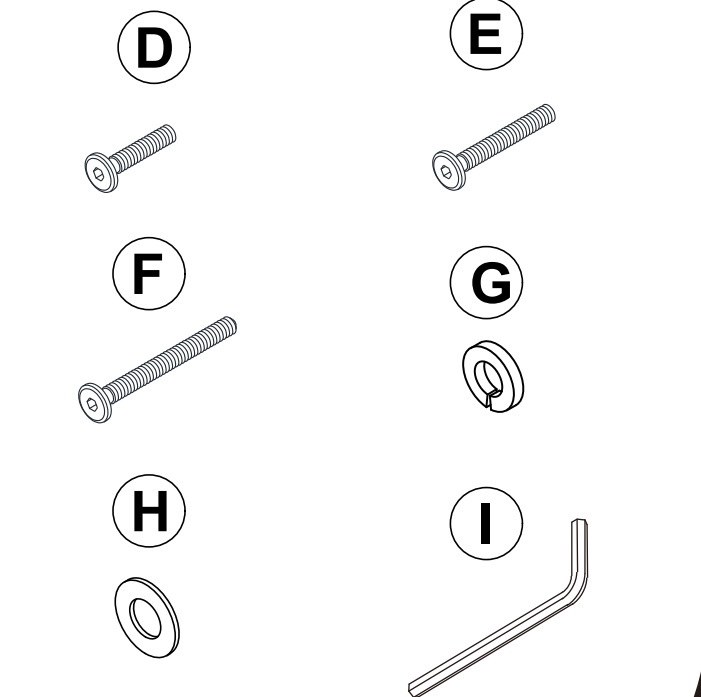

STEP 1

Attach Stretcher (B) to Leg (C) using Bolt M6 x 40 mm (E), Lock Washer M6 (G), Flat Washer M6 (H), Allen Key 4 (I) clockwise to tighten as shown below.

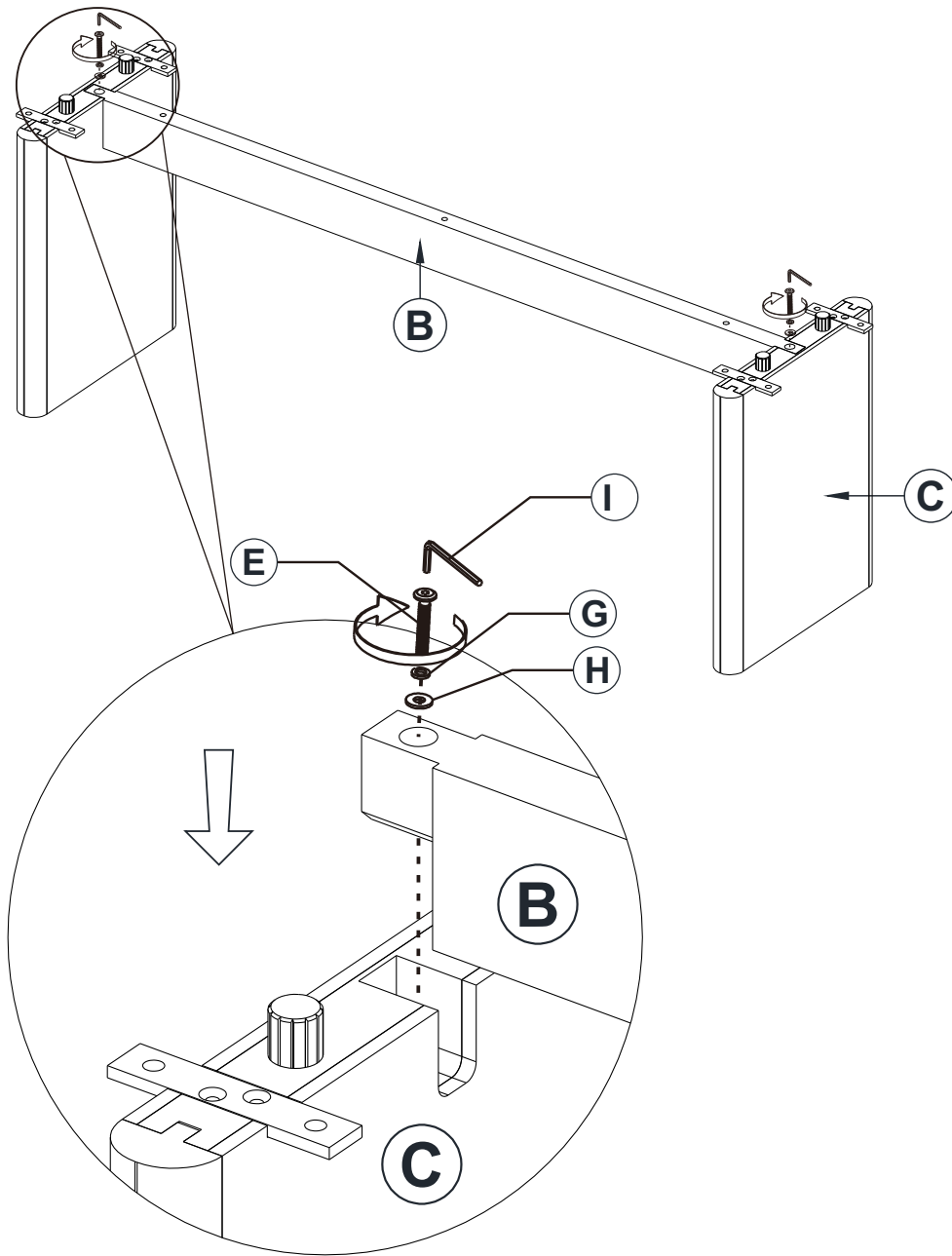

STEP 2

Attach Leg (C) to Top Table (A) using Bolt M6 x 25 mm (D) And Bolt M6 x 70 mm (F), Lock Washer M6 (G), Flat Washer M6 (H), Allen Key 4 (I) clockwise to tighten as shown below.

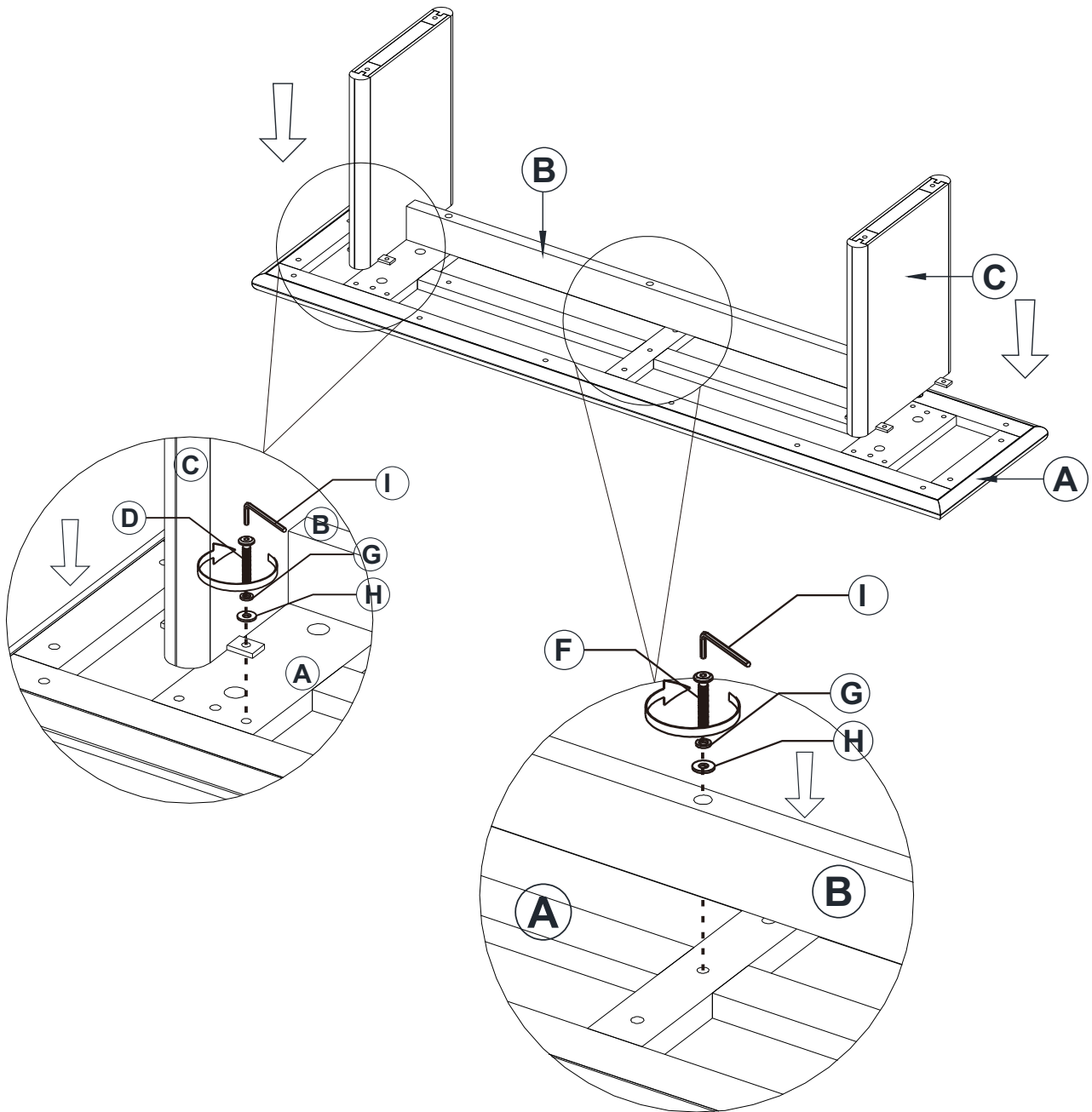

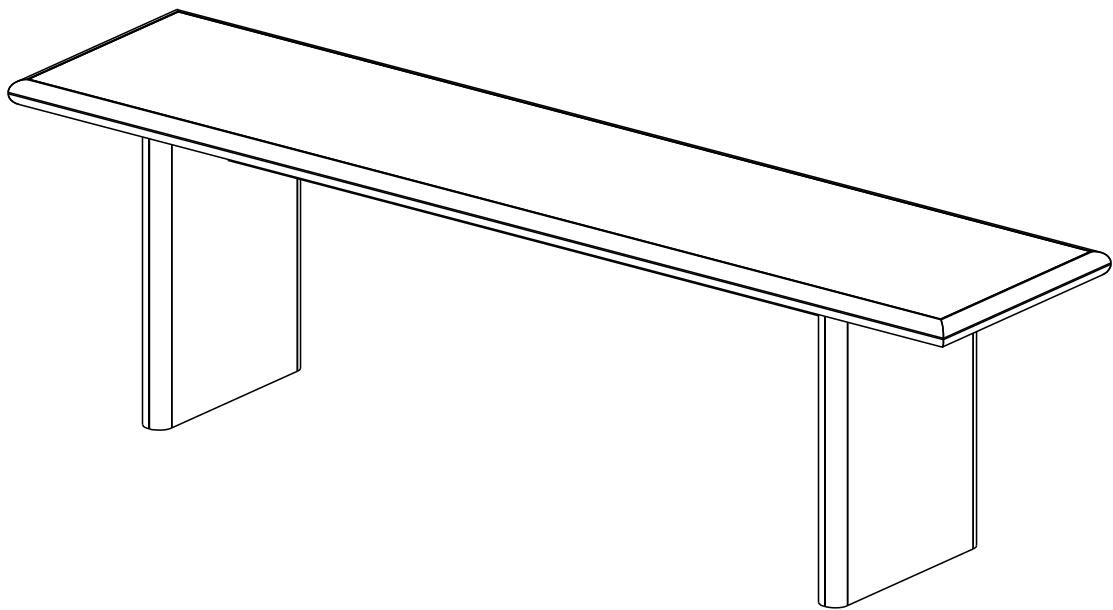

Congratulations

Assembly complete, Your Bench is ready to use.

(*) Caution : DO NOT OVERTIGHTEN

In any correspondence regarding this product, please include the complete Butler identification number located on the underside of the product.

We hope this product will be a useful and decorative addition to your home for years to come.

Copyright© Butler Specialty Company, 10 / 25